

# House of Switzerland, Sochi, Milano, Zürich, Davos, Rio, ...

2014

---



For "Presence Switzerland", the concept was developed for a multi-use platform with adequate space (730 m<sup>2</sup>) to serve public diplomacy and to promote Switzerland's interests at major international events. Timbatec constructed a robust, demountable timber construction system for this purpose.

## The project

The building ensemble consists of 4 buildings with up to three floors, whose overall silhouette evokes the modernity of contemporary Swiss wooden architecture. In this way, "Presence Switzerland" wants to present to the world a building document that combines tradition with contemporary Swiss architecture and design, built with Switzerland's "only renewable resource" - wood.

## The construction

Few different element types with always the same construction details allow to create a variety of different rooms. The construction concept is based on a consistently applied basic grid of 2.65 m so that all elements can be transported in sea containers (high cube). The premiere: The house was presented for the first time at the 2014 Winter Olympics in Sochi, then at the Road Show as part of the Giro del Gusto in Milan and at the World Championships in Athletics in Zurich on the Sechseläuteplatz. Further events all over the world are planned.

## The challenge

Timbatec's engineers were challenged to develop a robust, demountable, economical wooden construction system that was stable, safe and rainproof in any situation. The task was solved by means of a ribbed construction, which is repeated in the walls as well as in the floor slabs and roof.



Montage in Sochi



Interior visualization of the lounge



Inner courtyard

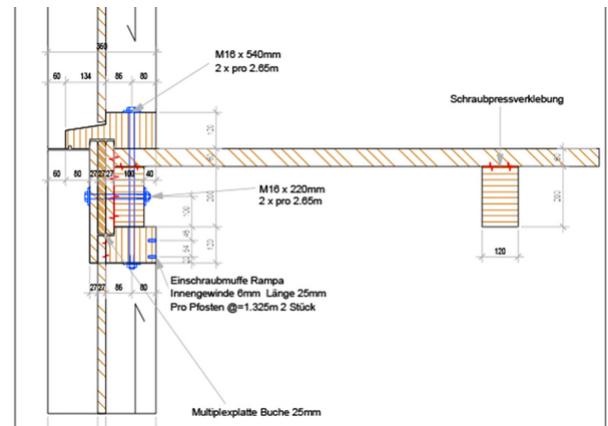

Connection detail: outer wall-floor slab

### Construction Data

- 120 m<sup>3</sup> Oak wood (boards and glulam)

### Services of Timbatec

- SIA phase 31 preliminary project
- Cost estimate
- SIA Phase 32 Construction project
- Fire protection planning
- Technical site management and site inspections
- Structural analysis and design
- SIA Phase 41 Tendering and comparison of offers
- technical construction management
- foundations

### Client

DFA, Presence Switzerland  
3003 Bern

### Architecture

Spillmann Echsle Architekten AG  
8038 Zurich

### Scenography

Ortreport  
8048 Zurich

### General contractor

Nüssli Schweiz AG  
8536 Hüttwilen

### Timber element construction

KiFa AG  
8355 Aadorf