

# Replacement new building farm store farm Waidhof, Zürich

2018

---



At the Waidhof farm in Zurich, the old farm store was replaced with a modern structure and a new cart shelter was built. The whole building project was realized with HSH certified Swiss wood.

## The project

The organic farm Waidhof is located north of the city of Zurich in district 11. It belongs to the city of Zurich and is leased by the Götsch-Rutz family. For direct sales from the farm, the farm has a farm store, which was replaced due to age and lack of space. In the new building there are rooms for the sales store, the production as well as a multi-purpose room. At the same time, a new shelter for the agricultural machinery was built. Timbatec Holzbauingenieure AG was responsible for all timber engineering services in this project, from the preliminary project to the tendering and the site inspections.

## The construction

The basement area of the farm store was built in cast-in-place concrete. All components above ground as well as the wagon shelter were realized in timber construction and with prefabricated elements. The wood used remains visible both inside and outside and characterizes the agricultural and at the same time modern style of the Waidhof.

## The challenge

In order to allow as much light as possible into the interior of the building, the skylights were inserted at the highest possible position, thus dispensing with a ridge. A filigree steel bar was used to absorb the static forces.



Tie rod for absorbing the static forces

### Dach Hofladen

Detail 106: Anschluss Zugstangen  
Schnitt Konstruktion

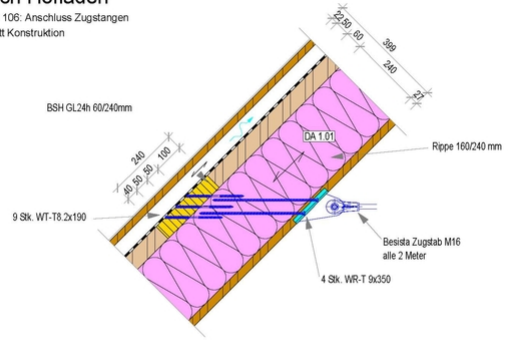

Anchoring tie rod in the roof



Assembly of wooden construction elements



Delivery of the wooden construction elements

### Construction Data

- Payloads farm store and production 5.00 kN/m<sup>2</sup>
- Exterior wall construction made of Swiss wood as far as possible 260 m<sup>2</sup>
- Interior wall construction made of Swiss wood 80 m<sup>2</sup>

### Construction costs

- Construction costs timber construction 290,000 francs

### Services of Timbatec

- SIA Phase 31 Preliminary design
- SIA Phase 41 Tendering and comparison of offers
- SIA Phase 51 Implementation project
- SIA Phase 52 Execution
- Statics and construction
- Site supervision and site inspections
- SIA Phase 32 Construction project
- Cost estimate

### Timber Construction Engineer

Timbatec Holzbauingenieure Schweiz AG

### Architecture

Felix J. Frey Architekten GmbH  
8004 Zurich

### Construction Management

Ziswiler + Partner AG  
8004 Zurich

### Civil engineer

Haag + Partner AG  
8700 Küsnacht ZH

### Timber constructor

Saxer Holzbau GmbH  
8046 Zurich