

Schoolhouse Marzili, Bern

2019



The Marzili school complex was built between 1946 and 1950 as a municipal girls' school. Today, it is considered an important contemporary witness of school building construction of the 20th century and is listed in the cantonal inventory as "worth protecting".

The project

Due to increasing numbers of children, the Marzili elementary school needed additional school space. The best solution proved to be an extension of the school complex with a new building in the western part of the site. The new building includes eleven classrooms with group rooms for the middle school, further rooms for group work and special lessons as well as a day school for 100 children. In addition to the new building, the three existing pavilions on the school grounds were repaired and adapted to today's requirements.

The construction

The light-looking three-story skeleton building is a hybrid of reinforced concrete and wooden elements. Concreted floor slabs with very large spans rest on wooden columns. The vertical columns are enclosed by insulated elements and thus form the load-bearing exterior walls. Horizontal pilaster strips made of spruce wood characterize the façade. Thanks to their trinity, they are more durable than if they were constructed from one piece of wood.

The challenge

We paid special attention to the connection of ceilings and walls. A foil protects the wall elements and the integrated beams against penetrating water and moisture from the wet concrete.

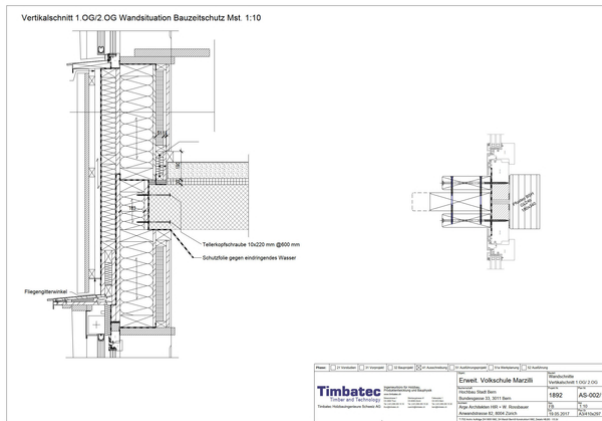

Construction Data

- Number of floors: 3
- Gross floor area: 3'585 m²

Construction costs

- BKP 1-9 (construction costs): 26
- 5 million Swiss francs
- BKP 2 (buildings): 22
- 15 million Swiss francs

Services of Timbatec

- SIA Phase 51 Implementation project
- Statics and construction
- Fire protection planning
- cost estimation
- Technical site supervision and site inspections

Client

Präsidialdirektion, Hochbau Stadt Bern
3001 Bern

Architect

Wolfgang Rossbauer Architekt GmbH
8004 Zurich

Architect

Hull Inoue Radlinsky Architekten GmbH
8004 Zürich

Timber construction

Herzog Bau und Holzbau AG
3001 Bern

Construction management

Omlin Architekten GmbH
3018 Bern

Photography

Jürgen Beck
Zurich